

FLANGIA 90° SAE SERIE 3000 PSI INTERLOCK
INTERLOCK 90° SAE FLANGE 3000 PSI SERIES

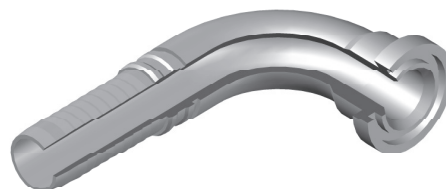
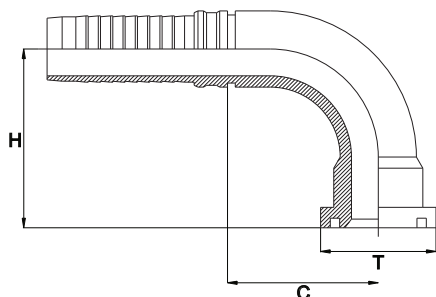

| Bar W.P. | Codice Part Number | Flangia Flange | Ø Int. Tubo Inch. Hose I.D. | T | C Cut - Off | H Drop |
|----------|--------------------|----------------|-----------------------------|------|-------------|--------|
| 350 | 90INTSF30001212 | 3/4" | 3/4" | 38,1 | 48,5 | 61,5 |
| | 90INTSF30001612 | 1" | 3/4" | 44,5 | 47,5 | 65,0 |
| 280 | 90INTSF30001616 | 1" | 1" | 44,5 | 63,0 | 77,0 |
| | 90INTSF30002016 | 1" 1/4 | 1" | 50,8 | 60,0 | 79,0 |
| 210 | 90INTSF30002020 | 1" 1/4 | 1" 1/4 | 50,8 | 78,5 | 99,0 |
| | 90INTSF30002420 | 1" 1/2 | 1" 1/4 | 60,3 | 74,0 | 105,5 |
| 185 | 90INTSF30002424 | 1" 1/2 | 1" 1/2 | 60,3 | 109,5 | 110,5 |
| | 90INTSF30003224* | 2" | 1" 1/2 | 71,4 | 125,5 | 127,0 |
| 170 | 90INTSF30003232 | 2" | 2" | 71,4 | 125,5 | 129,5 |

* Saldata

* Welded